

Slide-Type Wire-Wound Power Resistors

A tubular ceramic form has copper-alloy or chromium-alloy windings as a resistance element, with the resistor mount attachment method the same as the other resistors described. Except for the sliding contact surface on the windings, the entire component is coated with a high-temperature non-flammable resin. The adjustment mechanism is a rotating point that slides directly on the resistance element, which allows variation of the resistance value. Suitable for education, testing, load simulations, automation control installations, etc.

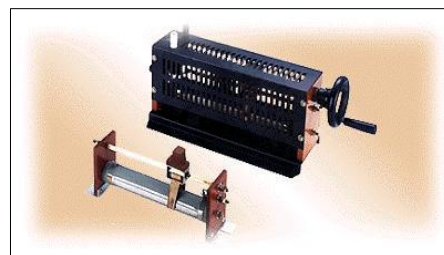

GENERAL SPECIFICATIONS

| Model | Power Rating[W] | Resistance Range [Ω] | Resistance Tolerance[%] |
|----------|-----------------|-------------------------------|-------------------------|
| BSR TYPE | 200-1300 | 0.5~13K | ± 10 |
| BSQ TYPE | 300-2000 | 0.5~200 | ± 10 |

DIMENSIONS

BSR TYPE 200W-1300W
 BSQ TYPE 300W-2000W
 Slide-type wave, variable wire-wound resistor.

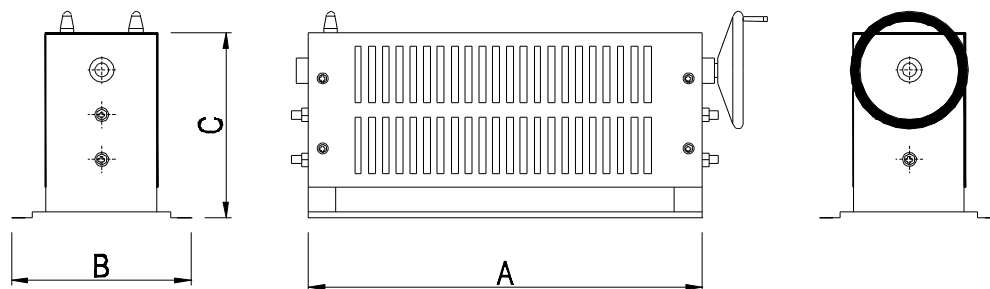

| Power Rating | | Dimensions(mm) | | | | | | Resistance [Ω] | |
|--------------|-------|----------------|-----------|-----------|-----------|--------|------------|-------------------------|---------|
| | | CASE | A ± 5 | B ± 3 | C ± 3 | 저항체 | 앞 판 | BSR | BSQ |
| BSR | BSQ | | | | | | | | |
| 200W | 300W | A | 285 | 130 | 135 | 28X250 | 120X70X10 | 0.5-2K | 0.5-30 |
| 400W | 600W | B | 360 | 150 | 185 | 40X325 | 170X70X10 | 0.5-4K | 0.5-60 |
| 500W | 750W | B | 360 | 150 | 185 | 40X325 | 170X70X10 | 0.5-5K | 0.5-75 |
| 1000W | 1500W | C | 570 | 160 | 200 | 60X535 | 185X100X10 | 0.5-10K | 0.5-150 |
| 1300W | 2000W | D | 680 | 160 | 200 | 65X645 | 185X100X10 | 0.5-13K | 0.5-200 |

ORDERING PROCEDURE EXAMPLE

